

D6**WOOD-COOKERS "DOMINO"**

mm 600x600xh860

CE EN -12815 certification

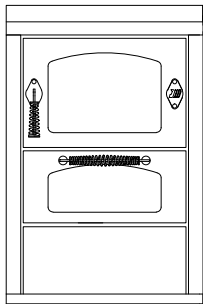
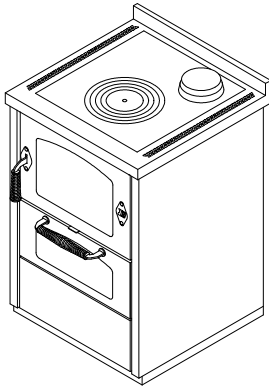

Colours:

White, Blue, Yellow, Green, Grey, Black, Red, Ivory, Rust, Stainless steel

STANDARD EQUIPMENT

- right or left top flue outlet \varnothing 130 mm
- right or left reversible fire door
- oven mm. 340x470xh150
- oven light and thermometer
- cast-iron hotplate mm 450x480 with maxi cooking ring set \varnothing 320 mm
- black doors
- s.steel handles D3
- s.steel frame mm 40 (total height 860 mm)
- s.steel base h. 30 mm

BY REQUEST

- s.steel doors
- s.steel handles D1
- rear or side flue outlet, right or left \varnothing 130 mm
- glass-ceramic hotplate (rear flue exit)
- plan variation
- external flue air

OPTIONALS:

- frontal handrail, s.steel or brass, 2 or 3 sides
- heavy-duty radiant hotplate
- stainless steel hotplate cover

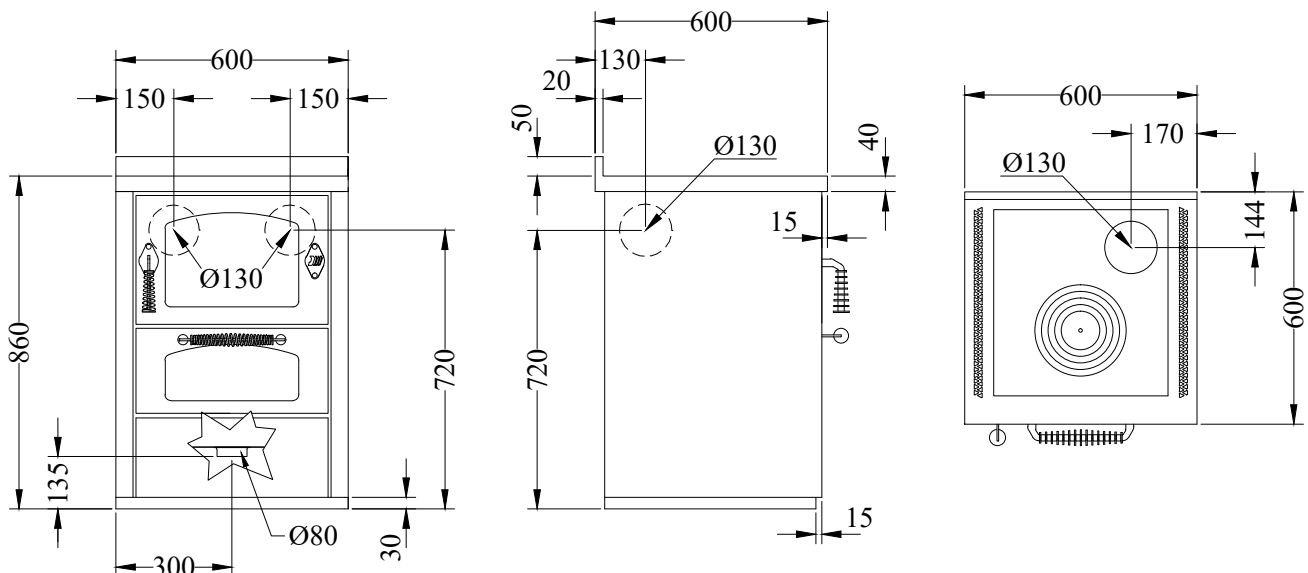
**DATA SHEET**

Nominal heat output: 5.5 kw

Efficiency: 85 %

Max heat output: 7.5 kw

Mean content of CO to 13% O₂: 0.08 %

Mean flue gas temperature: 238 C°

Flue gas mass flow: 6.3 g/s

Hearth dimensions (LxPxH): 38x25x25 cm

Average DUST content to 13% O₂: 22.9 mg/Nm³

Fill opening (LxH): 35x20 cm

External flue air: \varnothing 80 mm

Flue depression: 0.12 mbar

Net weight/packaging included: 180/195 kg